

TEMPO benches

design Timo Saarnio

ARKTIS



Tempo benches can be used in public spaces such as libraries, museums, and modern learning environments. They have a strong steel frame powder-painted in standard colours or according to the interior plan. The seat is made of solid wood or with upholstery. There is also a bench with a backrest (t47) available.



For outdoor use, the Tempo benches are produced with weatherproof materials, the seat being, for example, oak, and the frame being zinc-plated and powder-coated steel.

Thanks to its clear forms and structure, the Tempo bench can be used in various interiors and functions.



TEMPO benches

design Timo Saarnio

ARKTIS

t46 bench

t46t

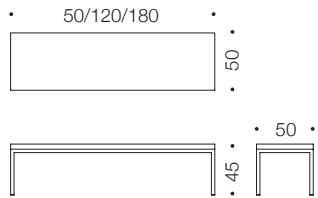

t46k

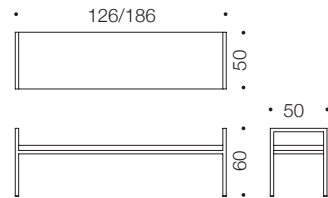

t46/100x100

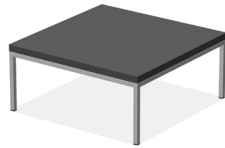
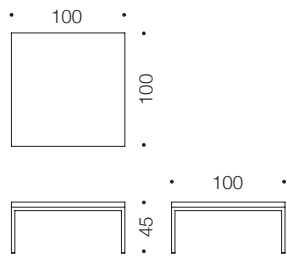

t46/D120

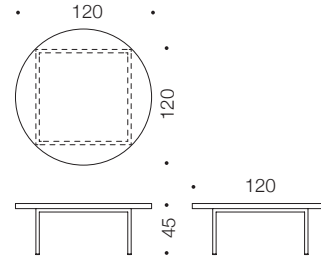

PRODUCT DETAILS

Metal parts painted (black / white / silvergrey)

Options

Legs and frames: special colour painted,
zinc plated for outdoor use
Seat: laminated, veneered, weatherproof material
Uphostery: double colour on one module

t47 bench with backrest

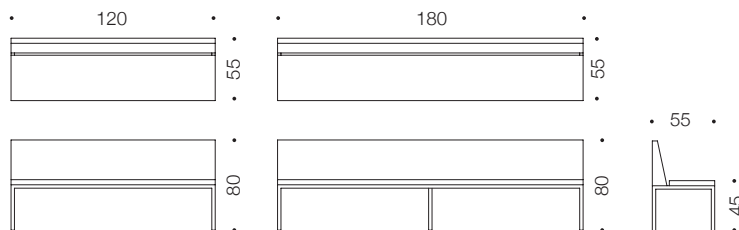

PRODUCT DETAILS

Metal parts painted (black / white / silvergrey)
Upholstery adds +10mm to seat height

Options

Legs and frames: special color painted
Uphostery: double color on one module